

# FRONT ELEVATION

SCALE: 1/4" = 1'-0"

BUILDER:



PROJECT:

10x14 Keystone Pavilion  
Hip Style

|       |          |      |
|-------|----------|------|
| FINAL | 12/28/21 | E.S. |
|       |          |      |
|       |          |      |
|       |          |      |



## DRAFTING CONCEPTS

5219 Old Strasburg Rd.  
Kinzers, PA 17535

P. 717-442-5053 F. 717-370-5925  
John@DraftingConceptsLLC.net

SCALE:  
AS NOTED

SHEET TITLE:  
Cover sheet

PROJECT NO.:  
D625-21

### CODE & LOADING INFORMATION

**OCCUPANCY TYPE**

- RESIDENTIAL STORAGE

**CONSTRUCTION TYPE**

- TYPE 5 B

**LOADING NOTES**

- 1st FLOOR ON GRADE

- GROUND SNOW = 30 PSF
- DEAD LOADS = 10 PSF
- BASIC WIND SPEED = 115 MPH
- EXPOSURE CLASS = B
- SEISMIC DESIGN CATEGORY = B
- FROST LINE DEPTH = 36"  
(OR BY LOCAL CODES)
- ASSUMED SOIL CLASS = GM, GC
- SOIL BEARING CAPACITY = 2000 PSF  
IF SOIL DIFFERS FROM ASSUMED ABOVE  
(REFER TO IRC CODES)

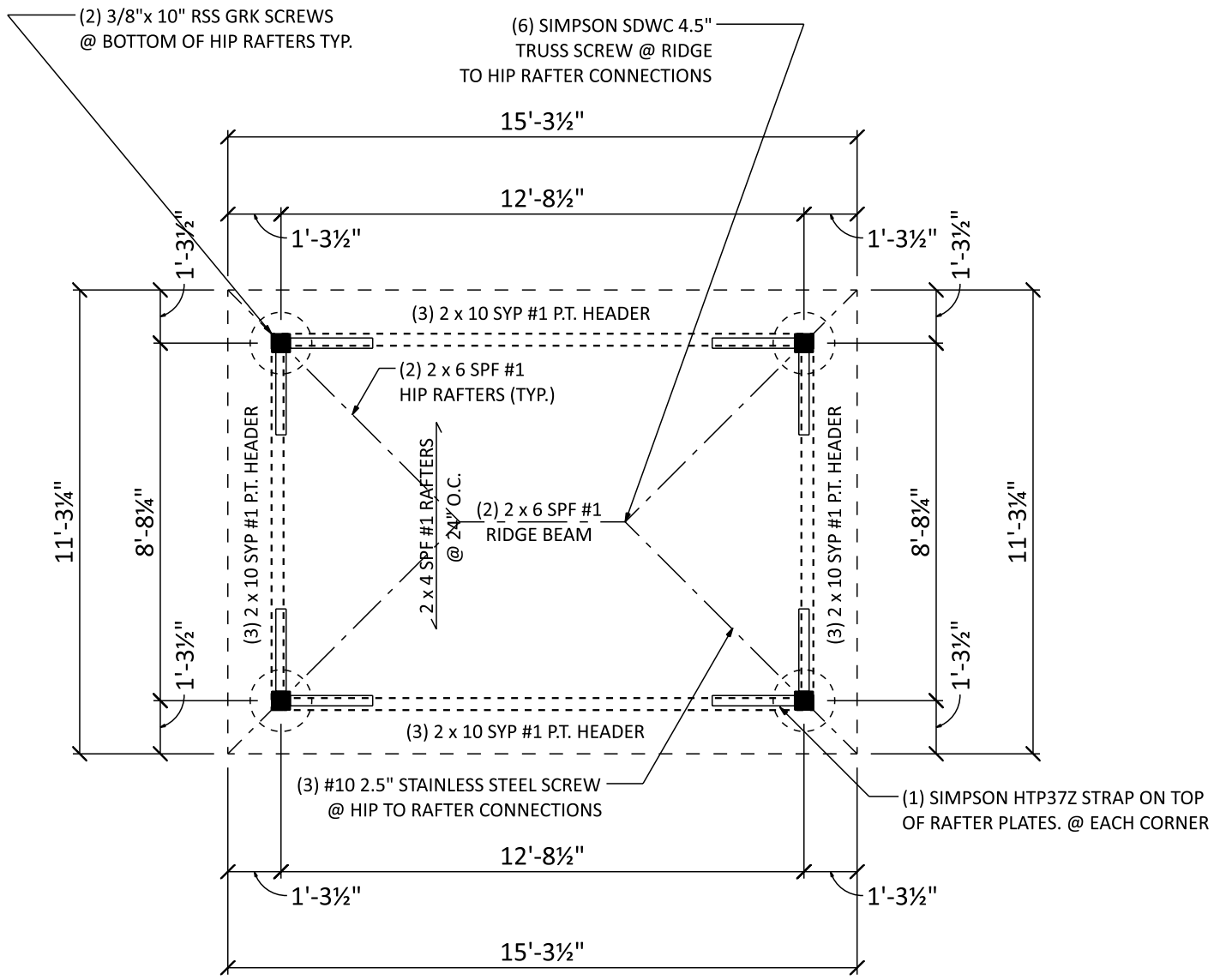

# FLOOR PLAN

SCALE: 1/4" = 1'-0"

BUILDER:  
  
 www.CREATIVEGAZEBOS.com

PROJECT:  
 10x14 Keystone Pavilion  
 Hip Style

|       |          |      |
|-------|----------|------|
| FINAL | 12/28/21 | E.S. |
|       |          |      |
|       |          |      |

  
**DRAFTING**  
 CONCEPTS  
 5219 Old Strasburg Rd.  
 Kinzers, PA 17535  
 P. 717-442-5053 F. 717-370-5925  
 John@DraftingConceptsLLC.net

SCALE:  
 AS NOTED

SHEET TITLE:  
 Floor plan

PROJECT NO.:  
 D625-21

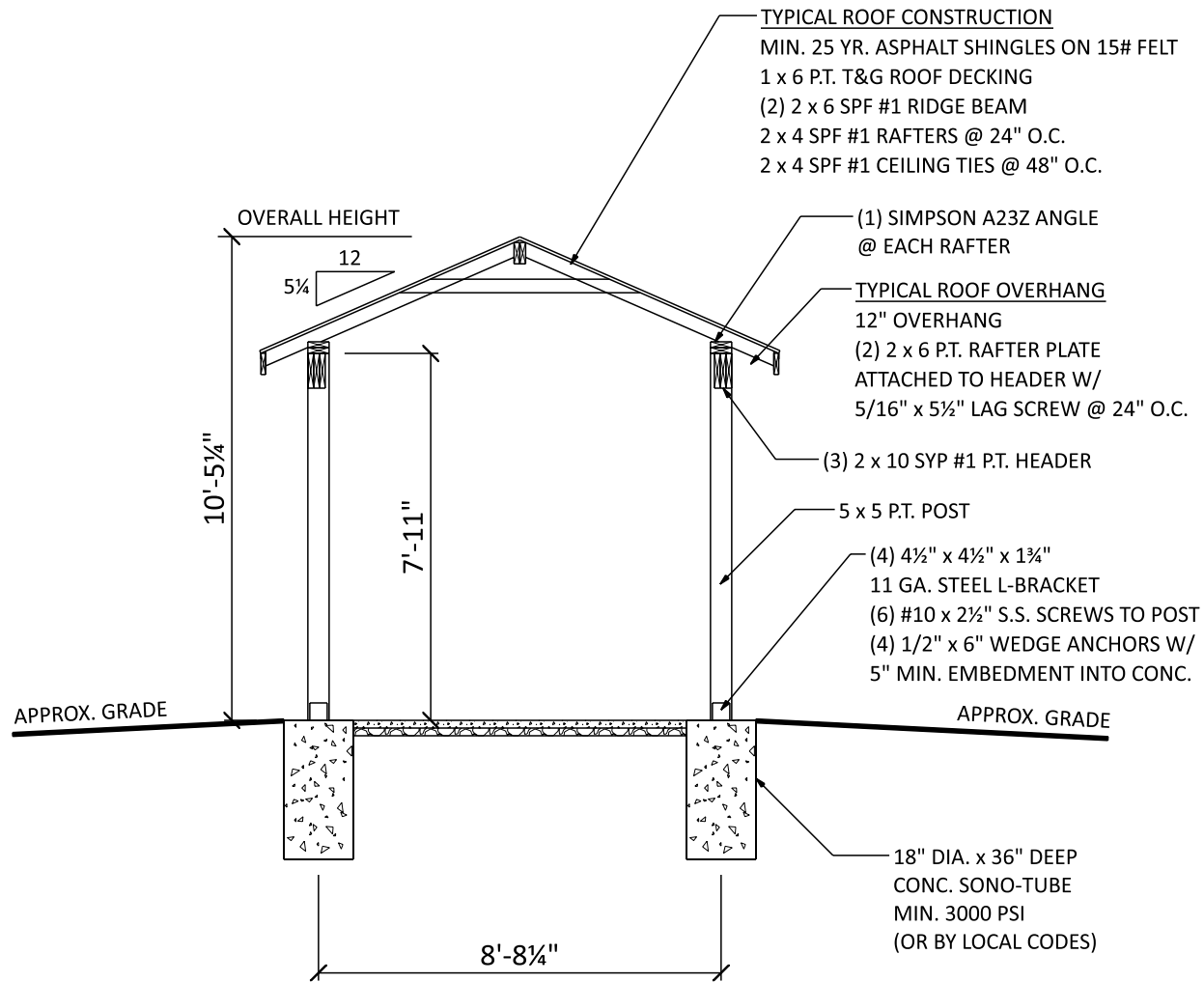

## SECTION A

SCALE: 1/4" = 1'-0"

BUILDER:



www.CREATIVEGAZEBOS.com

PROJECT:

10x14 Keystone Pavilion  
 Hip Style

| FINAL | 12/28/21 | E.S. |
|-------|----------|------|
|       |          |      |
|       |          |      |
|       |          |      |



**DRAFTING**  
 CONCEPTS

5219 Old Strasburg Rd.  
 Kinzers, PA 17535

P. 717-442-5053 F. 717-370-5925

John@DraftingConceptsLLC.net

SCALE:

AS NOTED

SHEET TITLE:

Section A

PROJECT NO.:

D625-21

3

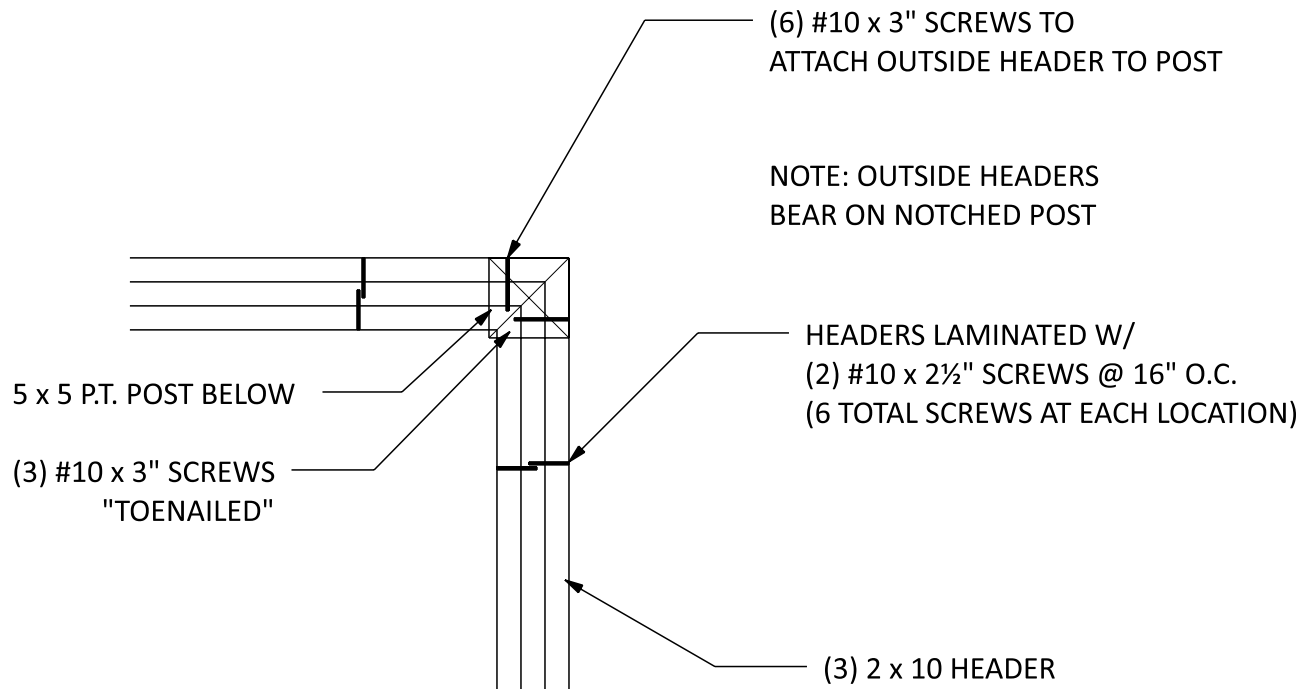

## HEADER TO POST

SCALE: 1" = 1'-0"

BUILDER:



www.CREATIVEGAZEBOS.com

PROJECT:

10x14 Keystone Pavilion  
Hip Style

| FINAL | 12/28/21 | E.S. |
|-------|----------|------|
|       |          |      |
|       |          |      |
|       |          |      |



**DRAFTING**  
CONCEPTS

5219 Old Strasburg Rd.  
Kinzers, PA 17535

P. 717-442-5053 F. 717-370-5925

John@DraftingConceptsLLC.net

SCALE:

AS NOTED

SHEET TITLE:

Header to post

PROJECT NO.:

D625-21

4

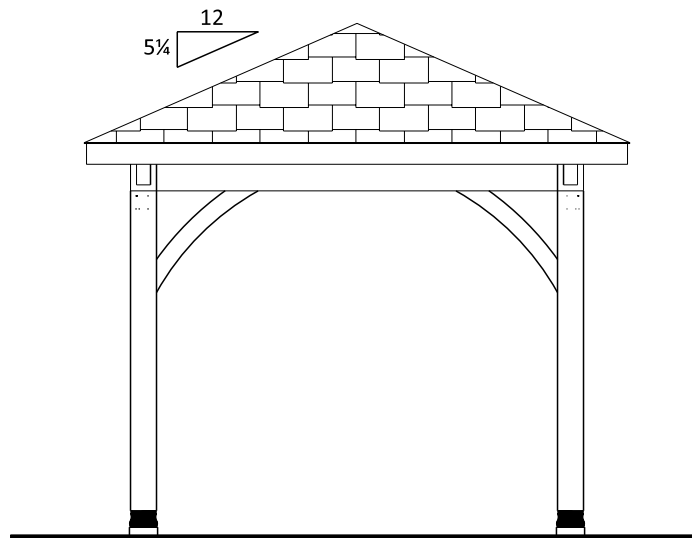

## RIGHT ELEVATION

SCALE: 1/4" = 1'-0"

BUILDER:



PROJECT:

10x14 Keystone Pavilion  
Hip Style

|       |          |      |
|-------|----------|------|
| FINAL | 12/28/21 | E.S. |
|       |          |      |
|       |          |      |
|       |          |      |



**DRAFTING**  
CONCEPTS

5219 Old Strasburg Rd.  
Kinzers, PA 17535

P. 717-442-5053 F. 717-370-5925  
John@DraftingConceptsLLC.net

SCALE:

AS NOTED

SHEET TITLE:

Right elevation

PROJECT NO.:

D625-21

5

**FASTENER SCHEDULE FOR STRUCTURAL MEMBERS**

| DESCRIPTION OF BUILDING ELEMENTS   | NUMBER AND TYPE OF FASTENER   | SPACING OF FASTENERS   |
|--|---|--|
| <b>ROOF</b>  |   |  |
| CEILING JOISTS TO TOP PLATE  | (3) 10d   | TOE NAIL   |
| CEILING JOISTS NOT ATTACHED TO PARALLEL RAFTER, LAPS OVER PARTITIONS   | (4) 10d   | FACE NAIL  |
| COLLAR TIE TO RAFTER, FACE NAIL OR 1X2 X 20 GAGE RIDGE STRAP TO RAFTER   | (4) 10d   | FACE NAIL EACH RAFTER  |
| RAFTER OR ROOF TRUSS TO PLATE  | (3) 16d   | TOE NAIL   |
| ROOF RAFTERS TO RIDGE, VALLEY OR HIP RAFTERS   | (4) 16d   | TOE NAIL   |
| <b>WALL</b>  |   |  |
| STUD TO STUD   | 16d   | 24" O.C. FACE NAIL   |
| BUILT-UP HEADER, TWO PIECES  | 16d   | 16" O.C. EA. EDGE FACE NAIL                                      |
| CONTINUOUS HEADER TO STUD  | (4) 8d  | TOE NAIL   |
| DOUBLE STUDS, FACE NAIL  | 10d   | 24" O.C.   |
| TOP PLATE TO TOP PLATE   | 10d   | 12" O.C. FACE NAIL   |
| DOUBLE TOP PLATES, MINIMUM 48-INCH OFFSET OF END JOINTS, FACE NAIL IN LAPPED AREA  | (8) 16d   | -----  |
| BOTTOM PLATE TO JOIST, RIM JOIST, BAND JOIST OR BLOCKING   | 16d   | 12" O.C. FACE NAIL   |
| BOTTOM PLATE TO JOIST, RIM JOIST, BAND JOIST OR BLOCKING (AT BRACED WALL PANEL)  | (3) 16d   | 16" O.C. FACE NAIL   |
| TOP OR BOTTOM PLATE TO STUD  | (3) 16d   | END NAIL   |
| TOP PLATES, LAPS AT CORNERS AND INTERSECTIONS  | (3) 10d   | FACE NAIL  |
| JOIST TO SILL, TOP PLATE OR GIRDER   | (4) 8d  | TOE NAIL   |
| RIM JOIST, BAND JOIST, OR BLOCKING TO SILL OR TOP PLATE (ROOF APPLICATIONS ALSO)   | 10d   | 6" O.C. TO NAIL  |
| BUILT-UP GIRDERS AND BEAMS, 2-INCH LUMBER LAYERS   | 10d   | 24" O.C. FACE NAIL AT TOP AND BOTTOM STAGGERED ON OPPOSITE SIDES |
| <small>WOOD STRUCTURAL PANELS, SUBFLOOR, ROOF AND INTERIOR WALL SHEATHING TO FRAMING AND PARTICLEBOARD WALL SHEATHING TO FRAMING</small> |   |  |
| $\frac{5}{16}$ " - $\frac{1}{2}$ "   | 6d COMMON NAIL (SUBFLOOR, WALL)<br>8d COMMON NAIL (ROOF)                                      | 6  |
| $\frac{3}{32}$ " - 1"  | 8d COMMON NAIL  | 6  |
| $\frac{1}{2}$ " GYPSUM SHEATHING   | 1 1/2" GALVANIZED ROOFING NAIL, STAPLE GALVANIZED,<br>1 1/2" LONG; 1 1/4" SCREWS, TYPE W OR S | 7  |
| $\frac{5}{8}$ " GYPSUM SHEATHING   | 1 1/2" GALVANIZED ROOFING NAIL, STAPLE GALVANIZED,<br>1 1/2" LONG; 1 1/4" SCREWS, TYPE W OR S | 7  |

**ALTERNATE ATTACHMENTS**

| NOM. MATERIAL THICKNESS (INCHES)   | DESCRIPTION OF FASTENER AND LENGTH (INCHES) | SPACING OF FASTENERS |                                |
|--|---|----------------------|--------------------------------|
|  |   | EDGES (INCHES)       | INTERMEDIATE SUPPORTS (INCHES) |
| <small>WOOD STRUCTURAL PANELS, SUBFLOOR, ROOF AND INTERIOR WALL SHEATHING TO FRAMING AND PARTICLEBOARD WALL SHEATHING TO FRAMING</small> |   |                      |                                |
| UP TO $\frac{1}{2}$ "  | STAPLES 15 GA. 1 $\frac{3}{4}$ "            | 4                    | 8                              |
|  | NAIL 2 $\frac{1}{4}$ "                      | 3                    | 6                              |
|  | STAPLES 16 GA. 1 $\frac{3}{4}$ "            | 3                    | 6                              |
| $\frac{23}{32}$ " AND $\frac{3}{4}$ "  | STAPLES 14 GA. 2                            | 4                    | 8                              |
|  | STAPLES 15 GA. 1 $\frac{3}{4}$ "            | 3                    | 6                              |
|  | NAIL 2 $\frac{1}{4}$ "                      | 4                    | 8                              |

TABLE R602.3(3) REQUIREMENTS FOR WOOD STRUCTURAL PANEL WALL SHEATHING USED TO RESIST WIND PRESSURES

| MINIMUM NAIL              |                      | MINIMUM WOOD STRUCTURAL PANEL SPAN RATING | MINIMUM NOMINAL PANEL THICKNESS (inches) | MAXIMUM WALL STUD SPACING (inches) | PANEL NAIL SPACING  |                     | MAXIMUM WIND SPEED (MPH) |     |     |
|---------------------------|----------------------|---|--|------------------------------------|---------------------|---------------------|--------------------------|-----|-----|
| SIZE                      | PENETRATION (INCHES) |   |  |                                    | EDGES (INCHES O.C.) | FIELD (INCHES O.C.) | WIND EXPOSURE CATEGORY   |     |     |
|                           |                      |   |  |                                    |                     |                     | B                        | C   | D   |
| 6d COMMON (2.0" X 0.113") | 1.5                  | 24/0                                      | 3/8                                      | 16                                 | 6                   | 12                  | 110                      | 90  | 85  |
| 8d COMMON (2.5" X 0.131") | 1.75                 | 24/16                                     | 7/16                                     | 16                                 | 6                   | 12                  | 130                      | 110 | 105 |
|                           |                      |   |  | 24                                 | 6                   | 12                  | 110                      | 90  | 85  |

**GENERAL NOTES**

- ALL CONSTRUCTION SHALL COMPLY WITH 2015 INTERNATIONAL RESIDENTIAL CODE.
- BUILDER MUST VERIFY ALL DIMENSIONS AND ACCURACY BEFORE CONSTRUCTION.
- WRITTEN DIMENSIONS SHALL TAKE PRECEDENCE OVER SCALED MEASUREMENTS.
- WINDOW AND DOOR, SIZES AND LOCATIONS, MAY VARY.
- ALL STRUCTURAL LUMBER SHALL BE SPRUCE-PINE-FIR #2 OR BETTER, UNLESS OTHERWISE NOTED.
- ANY WOOD IN CONTACT WITH MASONRY TO BE PRESSURE-TREATED WOOD.
- GRADE MUST SLOPE AWAY FROM STRUCTURE.

**BUILDER:**



www.CREATIVEGAZEBOS.com

**PROJECT:**

**10x14 Keystone Pavilion  
Hip Style**

|       |          |      |
|-------|----------|------|
| FINAL | 12/28/21 | E.S. |
|       |          |      |
|       |          |      |
|       |          |      |



**DRAFTING  
CONCEPTS**

5219 Old Strasburg Rd.  
Kinzers, PA 17535

P. 717-442-5053 F. 717-370-5925  
John@DraftingConceptsLLC.net

**SCALE:**

AS NOTED

**SHEET TITLE:**

General notes

**PROJECT NO.:**

D625-21

6